

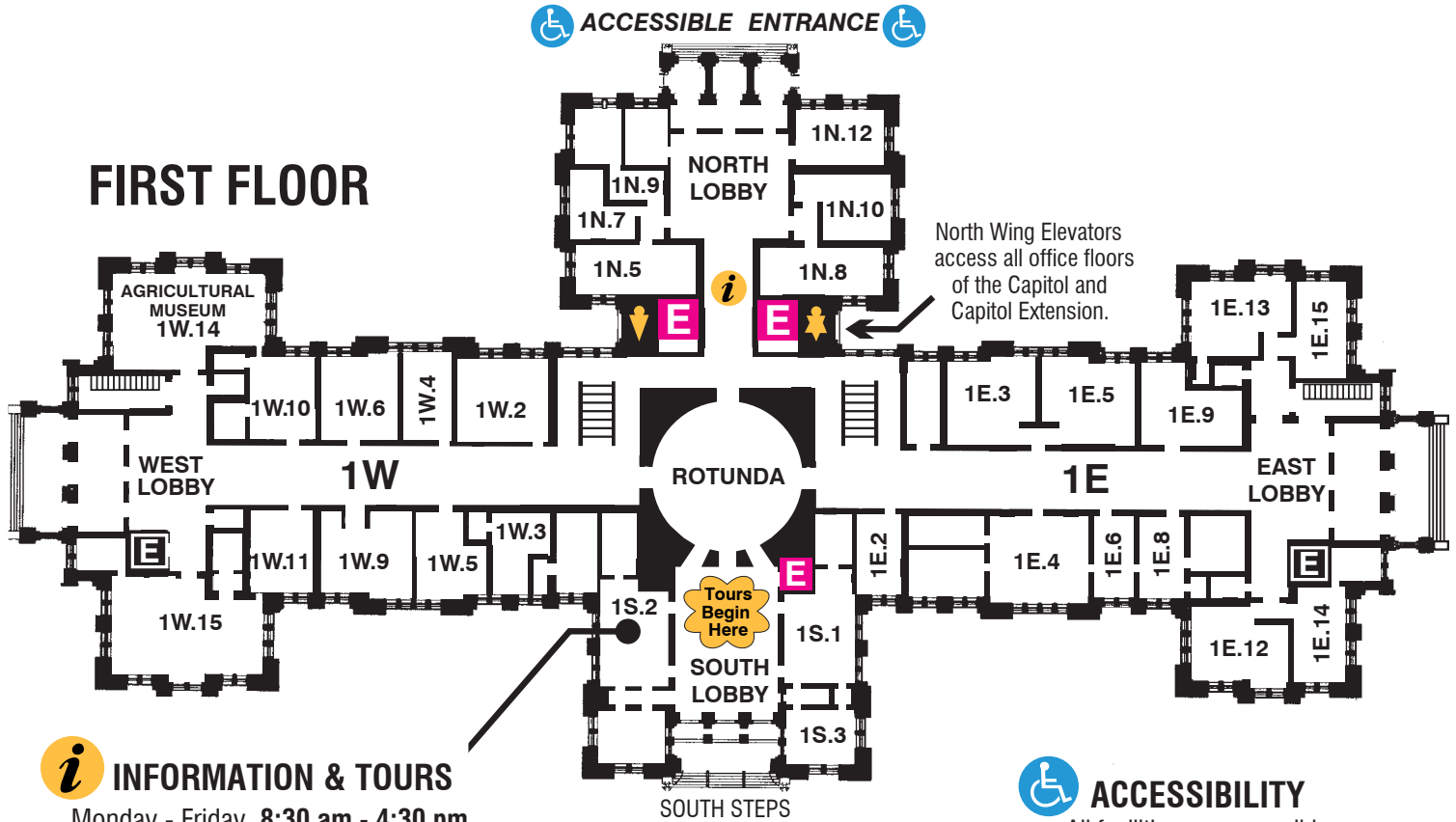

FIRST FLOOR



i INFORMATION & TOURS

Monday - Friday, 8:30 am - 4:30 pm

Saturday, 9:30 am - 3:30 pm

Sunday, Noon - 3:30 pm

Call 512.463.0063 for more information.



ACCESSIBILITY

All facilities are accessible to persons with disabilities.

For assistance call 512.463.0063.

GROUND FLOOR (Basement)

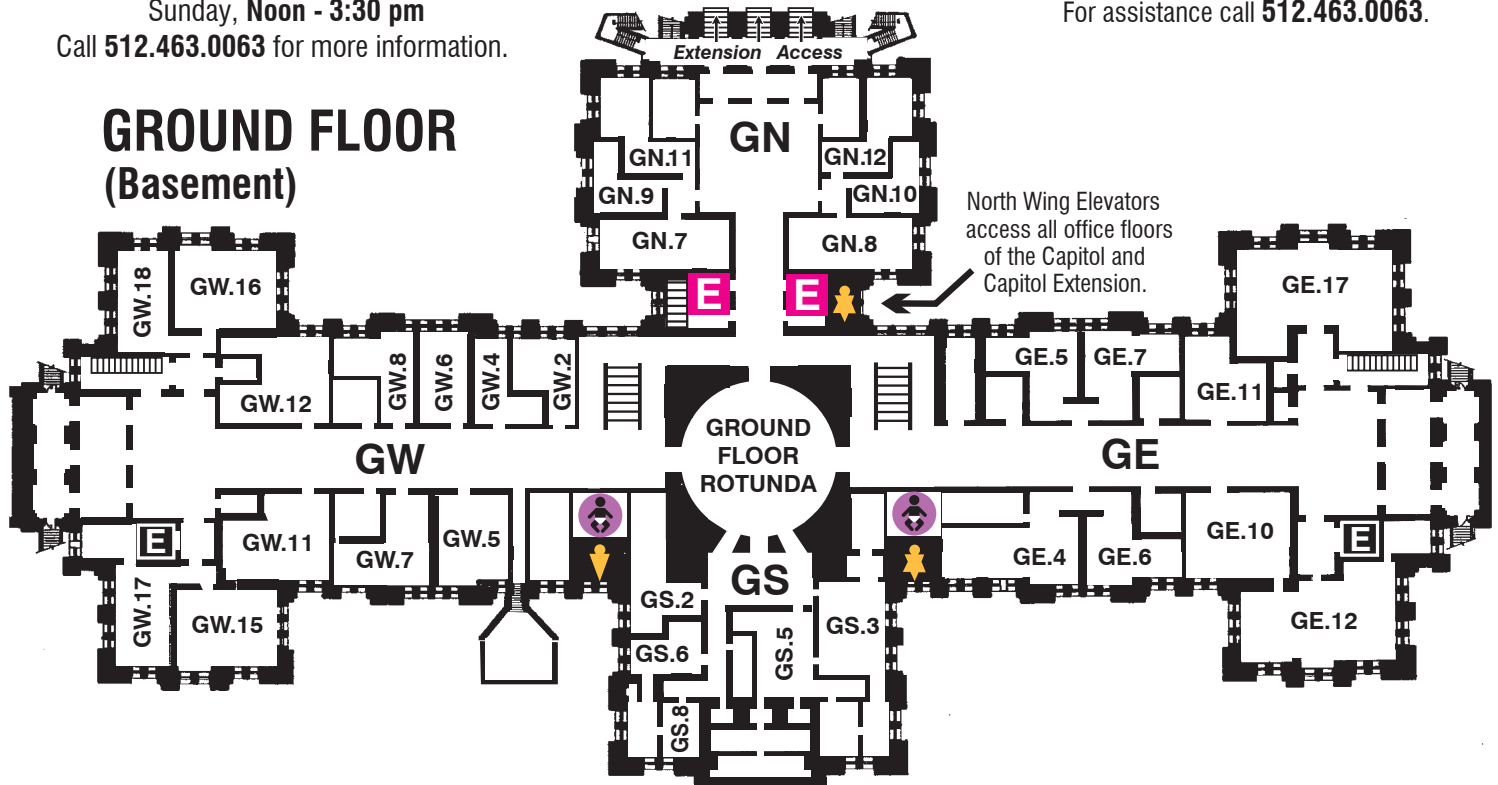

CAPITOL BUILDING GUIDE

FLOORS 1 & GROUND



INFORMATION & TOURS

Monday - Friday, 8:30 am - 4:30 pm

Saturday, 9:30 am - 3:30 pm

Sunday, Noon - 3:30 pm

Call 512.463.0063 for more information.



Baby Changing Tables
located in 2nd Floor
Restrooms

SECOND FLOOR

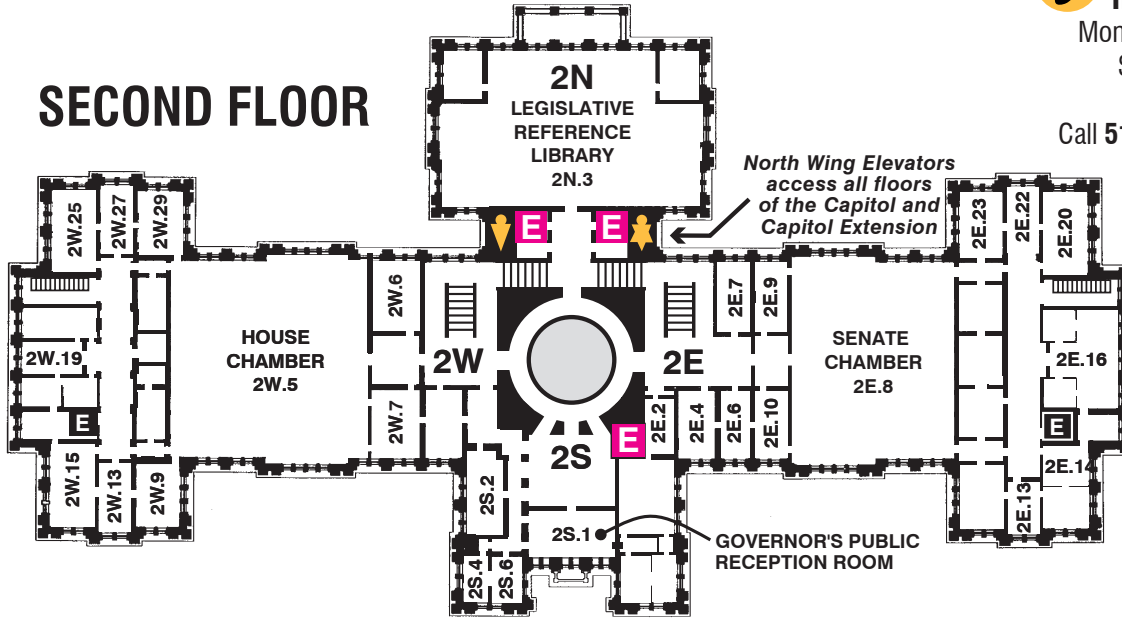

FOURTH FLOOR

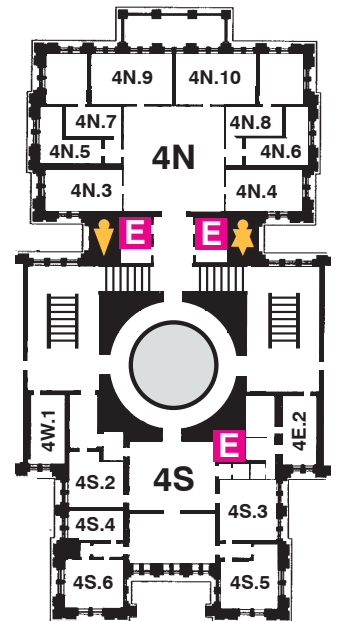

ACCESSIBILITY

All facilities are accessible
to persons with disabilities.

For assistance call
512.463.0063.

THIRD FLOOR

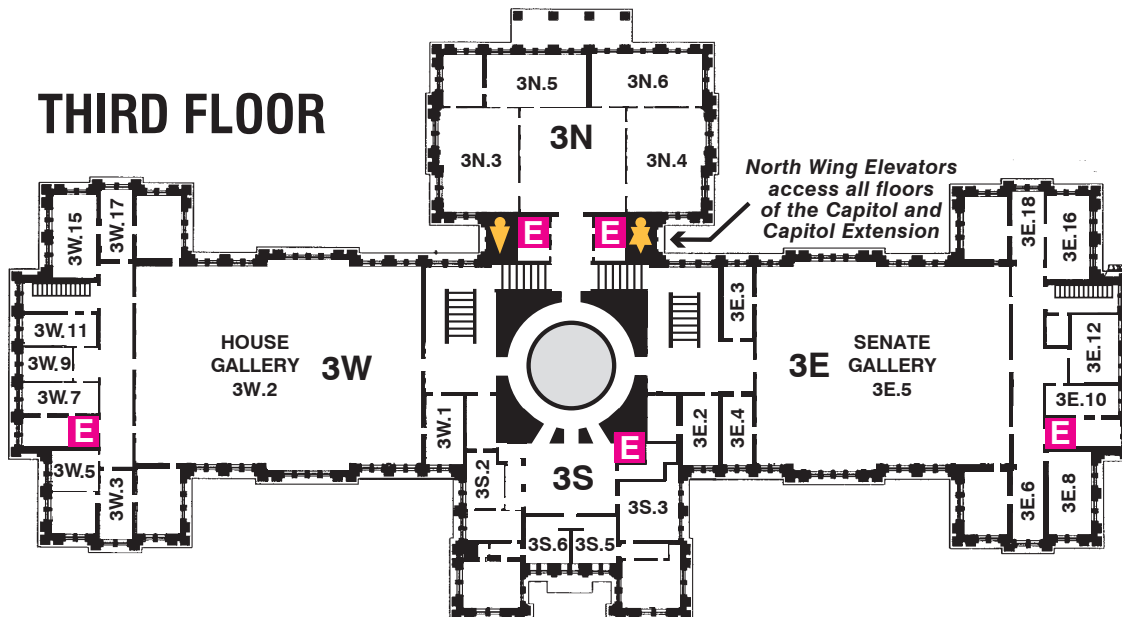

CAPITOL BUILDING GUIDE

FLOORS 2, 3 & 4

EXTENSION FIRST FLOOR (E1)

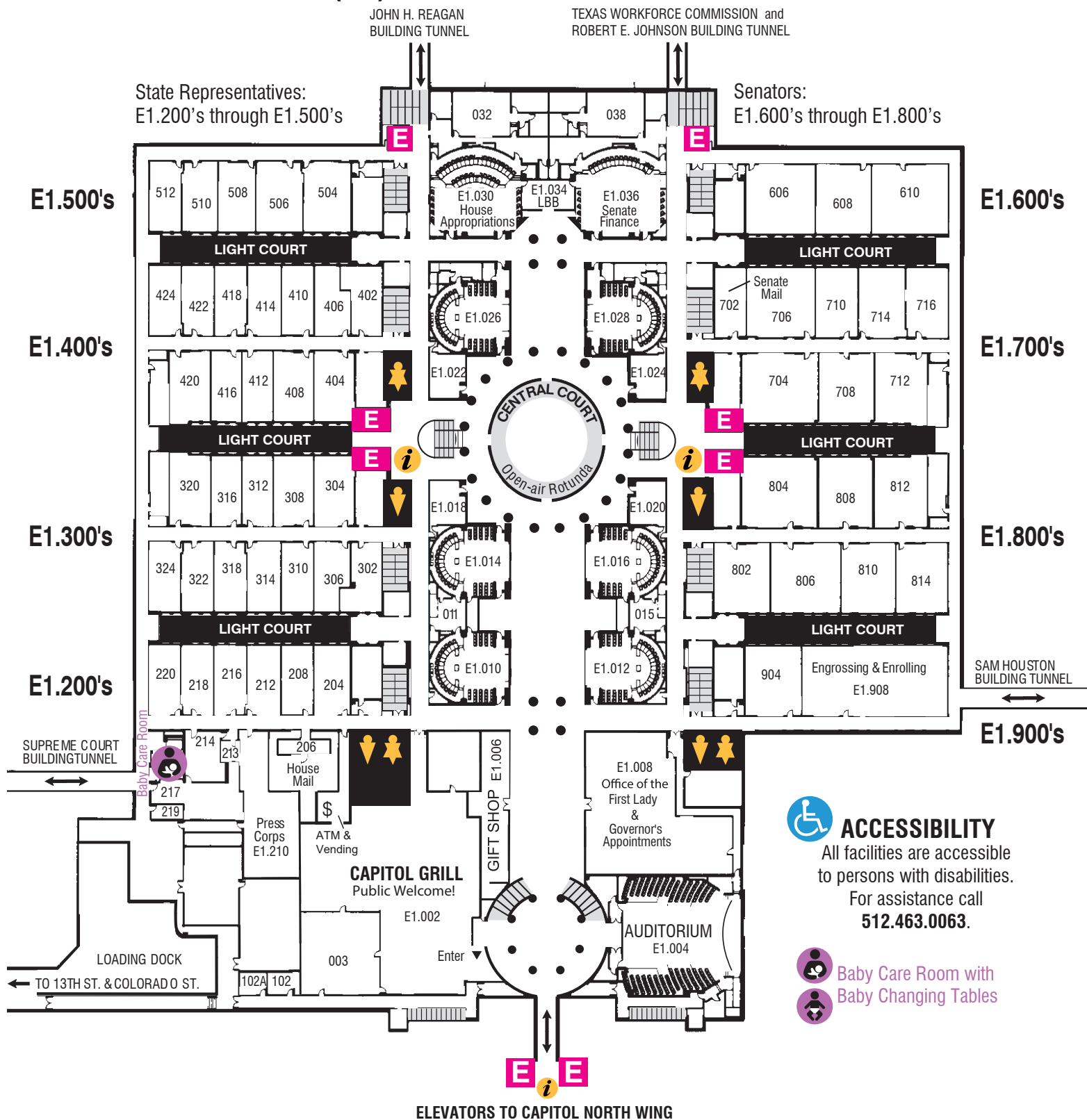

CAPITOL EXTENSION GUIDE

FLOOR E1

EXTENSION SECOND FLOOR (E2)

State Representatives Offices
E2.200 through E2.900's

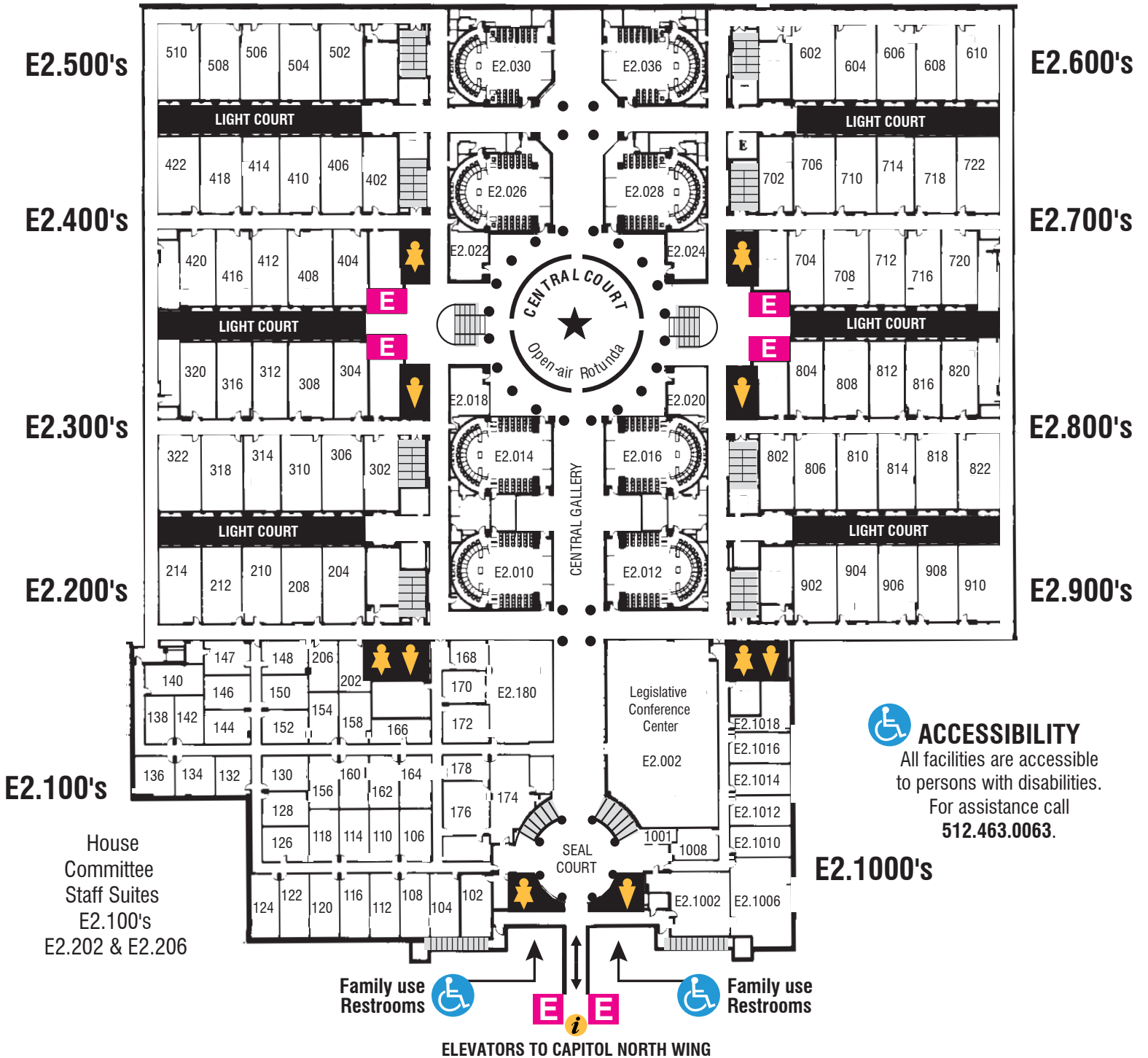

CAPITOL EXTENSION GUIDE FLOOR E2